

REGIONAL MUNICIPALITY OF OTTAWA-CARLETON  
MUNICIPALITÉ RÉGIONALE D'OTTAWA-CARLETON

REPORT  
RAPPORT

---

Our File/N/Réf.           **50 20-98-R088**  
Your File/V/Réf.

DATE                        16 September 1998

TO/DEST.                 Co-ordinator Transportation Committee

FROM/EXP.                Director Mobility Services and Corporate Fleet Services  
Environment and Transportation Department

SUBJECT/OBJET           **TRAFFIC CONTROL SIGNAL - PALLADIUM DRIVE  
(REGIONAL ROAD 88) AND FIRST LINE ROAD**

---

### **DEPARTMENTAL RECOMMENDATIONS**

**That the Transportation Committee recommend Council approve either:**

- 1. that a traffic control signal not be installed on Palladium Drive (Regional Road 88) and First Line Road in the City of Kanata as it is not warranted, or;**
- 2. that a traffic control signal be installed on Palladium Drive (Regional Road 88) and First Line Road, subject to the following conditions;**
  - a. that the City of Kanata pay all costs associated with the installation of the traffic control signal;**
  - b. that the City of Kanata be responsible for all costs associated with the traffic control signal's annual operation and maintenance, and;**
  - c. that the City of Kanata execute a legal agreement with the RMOC with respect to a. and b.**

### **BACKGROUND**

The City of Kanata, through Novatech Engineering Consultants Ltd., has requested that the Region approve the installation of a traffic control signal at Palladium Drive (Regional Road 88) and First Line Road.

## DISCUSSION

This Department only recommends the installation of a traffic control signal when the warrants, as established by the Ministry of Transportation of Ontario and adopted by Regional Council, are 100% warranted.

Based on 1998 counts signals are not warranted at this location; therefore, this Department cannot recommend this signal installation.

It is Council's policy that when an area municipality requests an unwarranted signal, the Region can recommend the signal provided the area municipality pays the full capital cost of the installation as well as the annual operation and maintenance costs.

Having reviewed the requested location, this Department has no objections to the signal installation. The current road geometry has adequate width and lane capacity; therefore, no road modifications are required.

## CONSULTATION

A draft copy of this report has been circulated to the Regional Cycling Advisory Group (RCAG) for comments. RCAG's comments, if any, will be available at Committee.

Signs indicating that traffic control signals are being proposed will be installed at the intersection. Included on the sign will be an information and/or comment contact phone number.

Since no road modifications are required for the installation of this signal, a public hearing is not required under Council policy.

## FINANCIAL IMPLICATIONS

No financial commitments are associated with this report as all costs are to be borne by the City of Kanata, including the annual operation and maintenance costs.

*Approved by  
Doug Brousseau*

GK/sc

Attach. ( 2 )

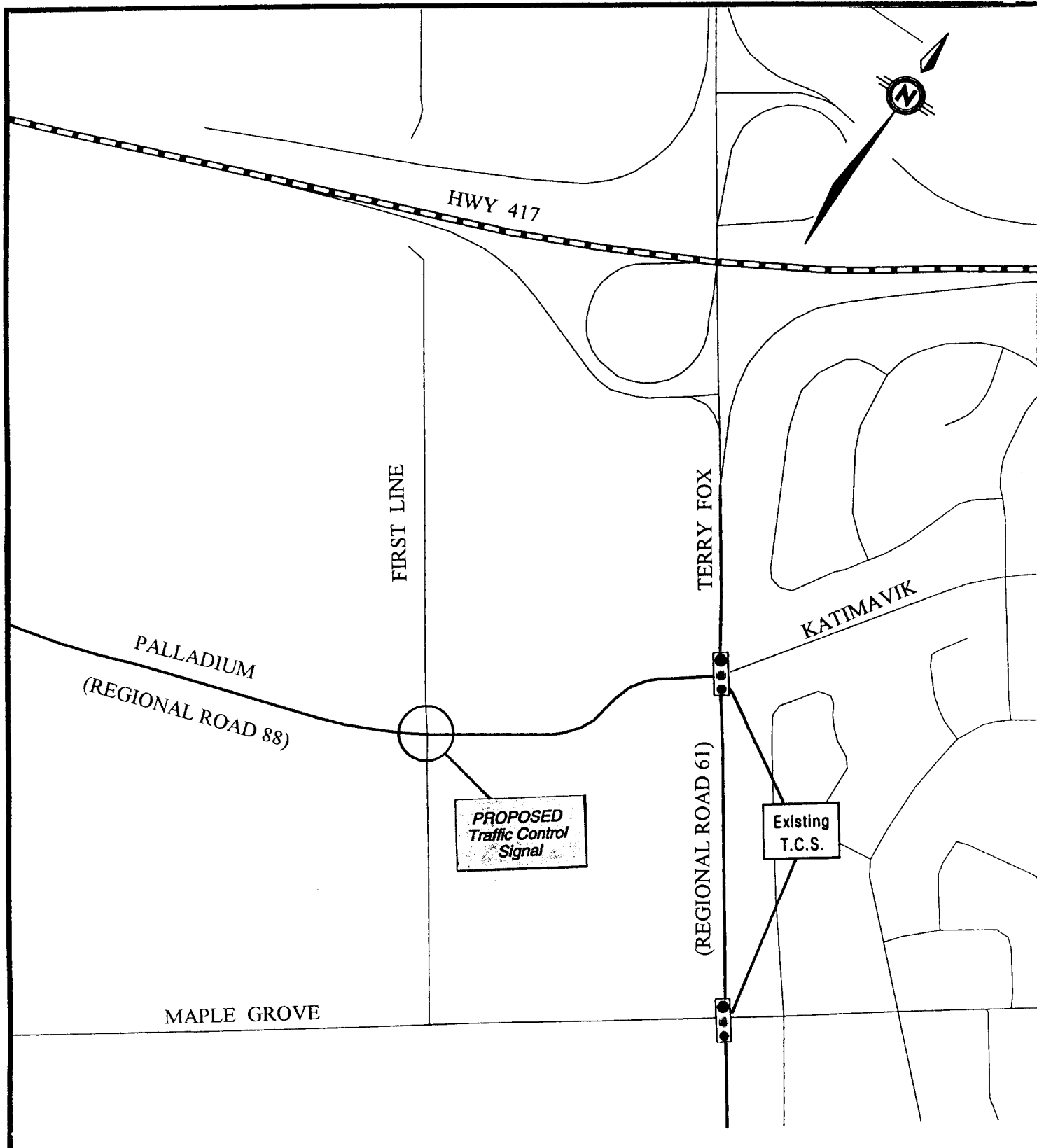

**TRAFFIC CONTROL SIGNALS -  
PALLADIUM DRIVE (REGIONAL ROAD 88)  
AND FIRST LINE ROAD**



**Ottawa-Carleton**

**MOBILITY SERVICES**  
Environment & Transportation Department

Drawn By

Checked By

Approved By

**G.K.**

Scale

**N. T. S.**

Date

**SEPTEMBER 1998**