

Our File/N/Réf. 14-8-2000
Your File/V/Réf.

DATE: 19 June 2000

TO/DEST: Co-ordinator, Transit Services Committee

FROM/EXP. General Manager

SUBJECT/OBJET: **SEATING CONFIGURATION
NEW FLYER ARTICULATED BUSES**

DEPARTMENTAL RECOMMENDATION

That the Transit Services Committee receive this report for information.

BACKGROUND

At the Transit Services Committee meeting of 24 May 2000, Chair a. Loney requested that information on the configuration of seats in the new articulated buses from New Flyer be brought back to the June Transit Services Committee meeting.

Seating arrangements for the New Flyer articulated buses scheduled for delivery during the last quarter of 2000 provide for fifty-two seated passengers. Each vehicle can accommodate two wheelchairs, however when the chair positions are occupied, the number of seats is reduced to forty-six. Seat construction combines a stainless steel frame with padded seat cushion and back. The cloth material is vandal resistant which provides a clean modern look while minimizing the effects of marking devices.

The two wheelchair positions are located on the left side of the bus behind the operator. This location provides for wheelchair manoeuvrability while retaining maximum passenger seats. Alternate locations such as chairs opposite each other as provided on the Novabus LSF low floor, are impractical due to exit door location and the loss of an additional seat when the wheelchair position is occupied. A maximum clear aisle width of 31.88" has been maintained to provide the best possible access to chair locations and to maintain passenger flow to the rear of the bus.

Wheelchair locations are rear facing, and equipped with a padded backboard and floor-mounted stanchion bars. No belts or attaching fixtures are required for rear-facing wheelchair positions. Wheelchair passengers have access to the passenger chime that is mounted on the underside of the flip-up passenger seats. This distinctive chime alerts the operator with an audible and visual signal indicating that the kneeling feature and ramp will be required. Two passenger seats are mounted in the turntable area to provide the maximum number of seats. The rear section of the bus is accessed by two steps: this is required to clear the rear axle and to allow forward-facing seats.

Seating configuration, drawing number 60-0001 is attached for reference.

*Approved by
Gordon Diamond*

ITEM QTY. DESCRIPTION PART # W

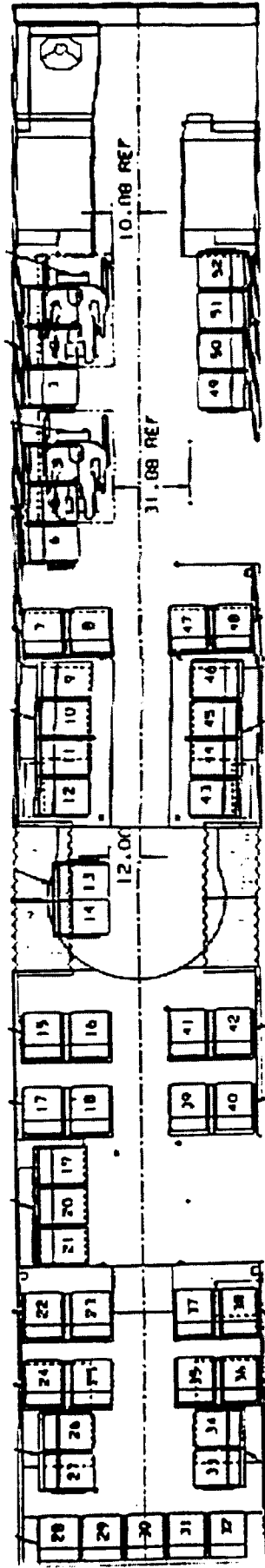

Rear Door

Centre Door

Front Door

A	RELEASED	WFK	06/14/00
	NO.	REVISION	ECN BY DATE CHK. AF

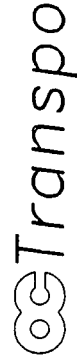

OTTAWA - CARLETON REGIONAL TRANSIT COMMISSION

SEATING PLAN - NEW FLYER BUS
MODEL No. D60LF

NOTE: TOLERANCES UNLESS OTHERWISE SPECIFIED
 FOR ANGULAR DIMENSIONS ± 0°30'
 FOR DECIMAL DIMENSIONS XXX ± 0.005"
 FOR DECIMAL DIMENSIONS .XX ± 0.010"
 FOR HOLE LOCATIONS ± 1/32"
 FOR OTHER DIMENSIONS ± 1/16"
 ARE TO BE NON-CUMULATIVE

DRAWN BY: WI: 06/14/00
 CAD DISC FILE: 6000011A
 LAST DISC REV: WI: 06/14/00



ALL OF THE INFORMATION CONTAINED ON THIS DOCUMENT IS THE EXCLUSIVE
 PROPERTY OF GLOBAL PROCESSING SYSTEMS INC. THIS DOCUMENT
 IS DISCLOSED WITH THE UNDERSTANDING THAT IT WILL BE RETAINED IN
 CONFIDENCE, AND RETURNED UPON DEMAND. IT IS NOT TO BE DUPLICATED,
 REPRODUCED, COPIED, OR TRANSMITTED IN ANY FORM OR BY ANY MEANS,
 ELECTRONIC OR MECHANICAL, INCLUDING PHOTOCOPYING, RECORDING,
 OR BY ANY INFORMATION STORAGE AND RETRIEVAL SYSTEM.